

## Issue 6

Attach the Left Front Disc Brake, then add the precisely reproduced Engine detail parts.

# Assemble the Disc Brake and Cylinder Block

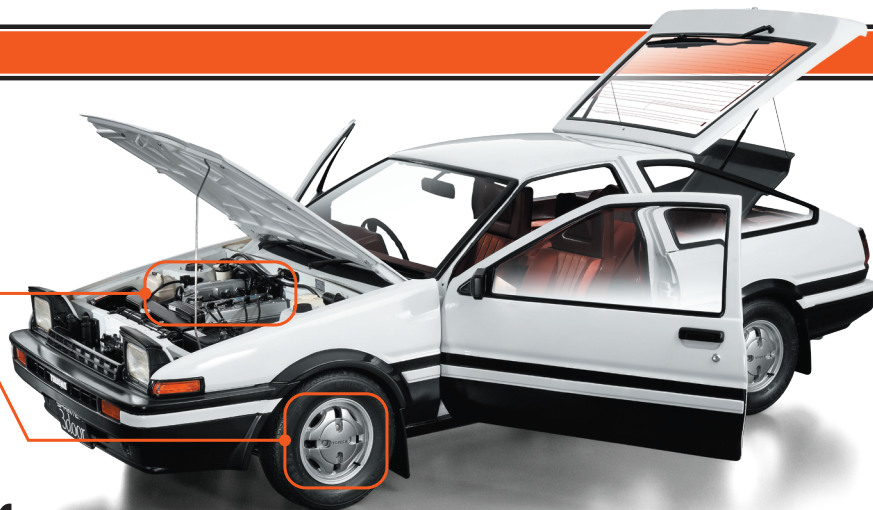

※ In this guide "Left" or "(L)", and "Right" or "(R)", refer to the direction as viewed from the driver's seat.

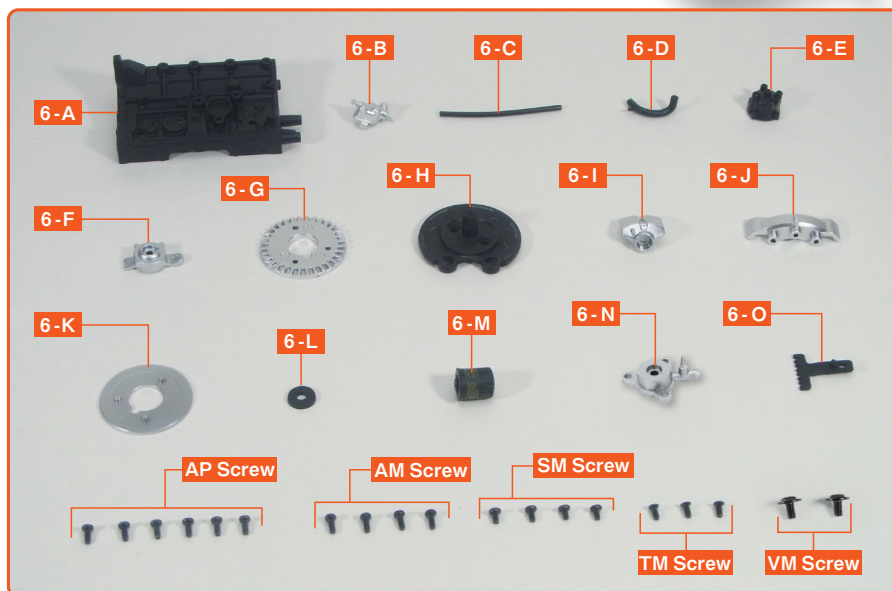

- 6-A** Cylinder Block (L)
- 6-B** Cylinder Head Rear Plate
- 6-C** Heater Outlet Hose
- 6-D** Water Outlet Pipe
- 6-E** Distributor Cap
- 6-F** Distributor
- 6-G** Brake Disc (1)
- 6-H** Brake Disc Dust Cover
- 6-I** Brake Caliper (1)
- 6-J** Brake Caliper (2)
- 6-K** Brake Disc (2)
- 6-L** Washer
- 6-M** Oil Filter
- 6-N** Oil Filter Bracket
- 6-O** Plug Code Clamp
- AP Screw** (1.7×4 mm) ×6 (1 spare)
- AM Screw** (1.7×4 mm) ×4 (1 spare)
- SM Screw** (1.7×3 mm) ×4 (1 spare)
- TM Screw** (1.7×4 mm) ×3 (1 spare)
- VM Screw** (2.3×4×6 mm) ×3 (1 spare)

View the follow-along video



※Due to the model's design, the shapes of some parts may differ from those of the real vehicle.

### step 1 Attach the Disc Brake to the Left Front Member

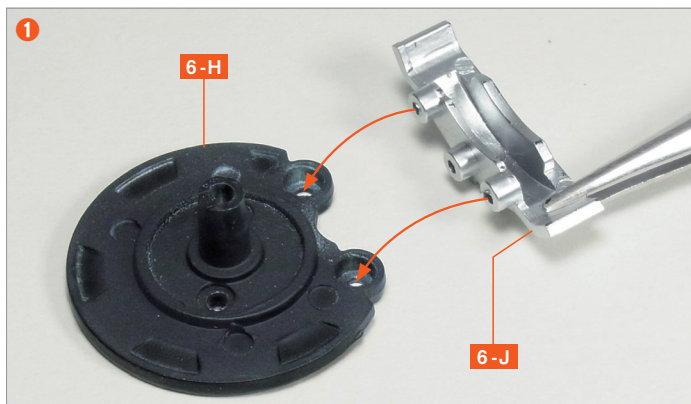

Align the protrusions on the **Brake Caliper (2)** 6-J with the two holes on the **Brake Disc Dust Cover** 6-H.

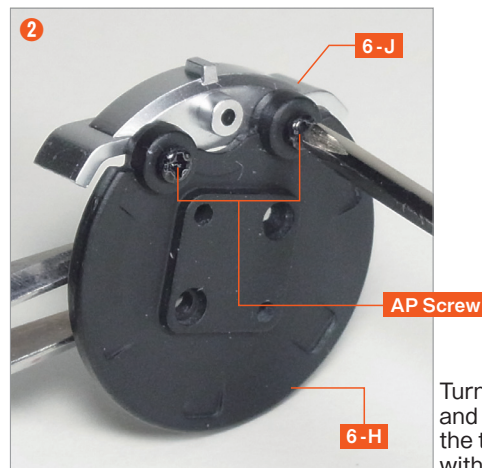

Turn **6-H** over and secure it at the two points with **AP screws**.

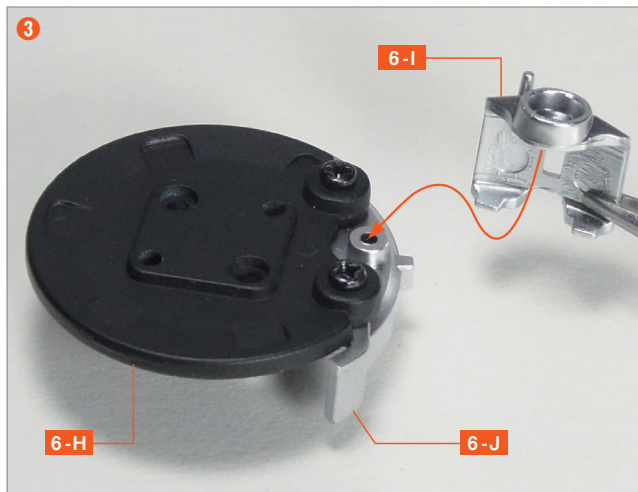

Place **Brake Caliper (1) 6-I** over **6-J**, fit the square hole of **6-I** onto the square peg of **6-J**, and align the screw holes of **6-I** and **6-J**.

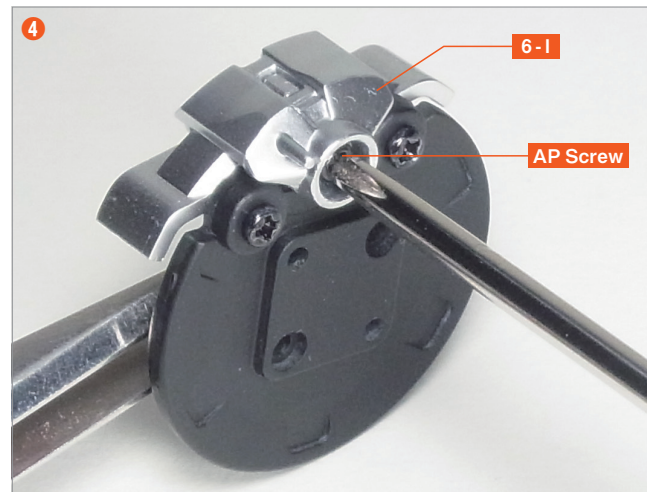

Secure **6-I** with an **AP screw**.

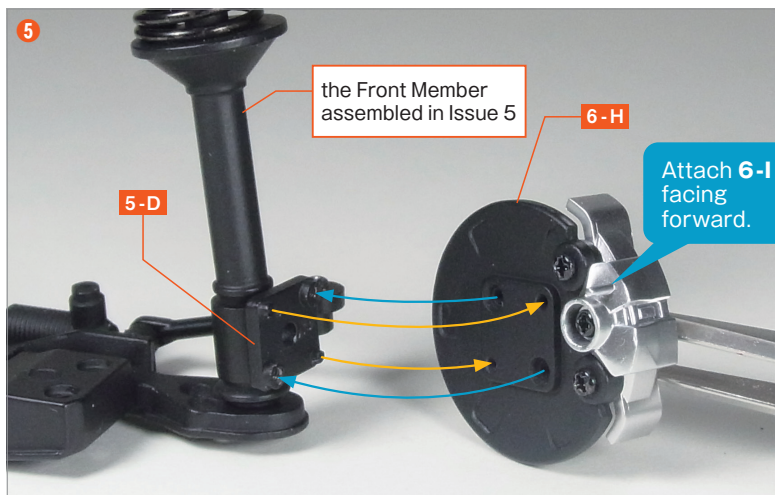

Prepare the **Front Member** assembled in Issue 5, and combine the **Knuckle Arm (L) 5-D** with **6-H**.

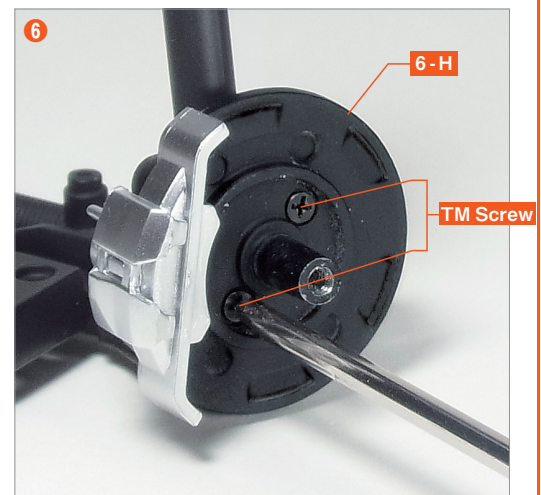

Align the screw holes of **5-D** and **6-H**, and secure with **TM screws** in two places.

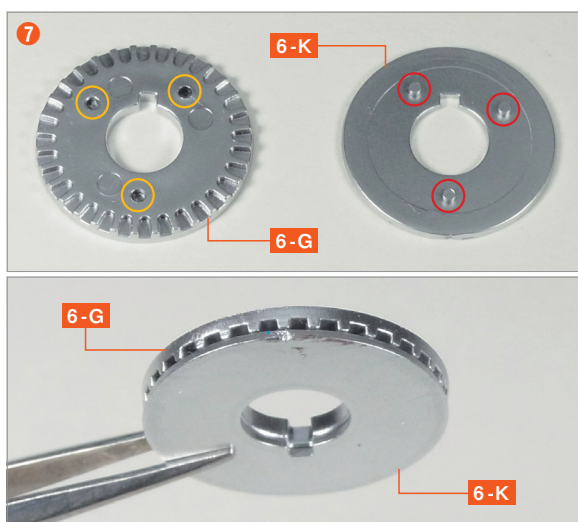

Align the three pins and holes of **Brake Disc (1) 6-G** and **Brake Disc (2) 6-K**, and fit them together.

**Step complete**





## step 2 Attach the Distributor

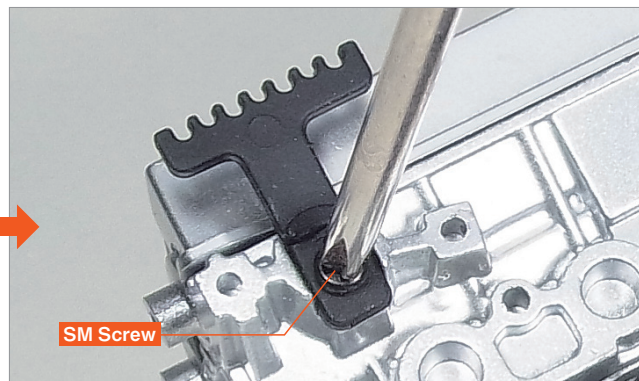
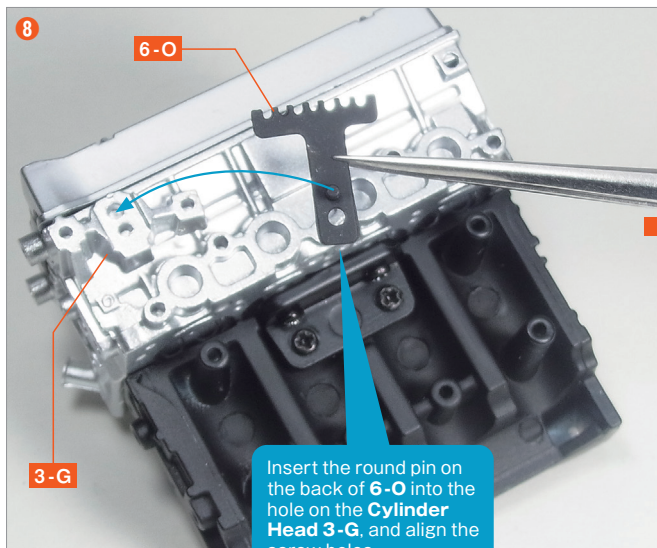

Prepare the Cylinder Block assembled in Issue 5, place the **Plug Code Clamp 6-O** as shown, and secure it with an **SM screw**.

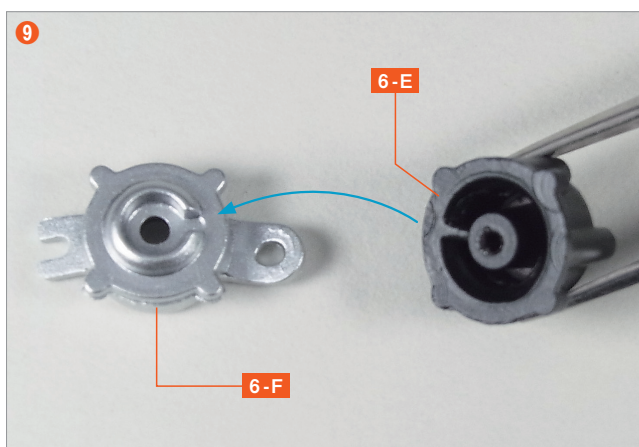

Align the protrusions on the back of the **Distributor Cap 6-E** with the notches on the **Distributor 6-F** and fit them together.

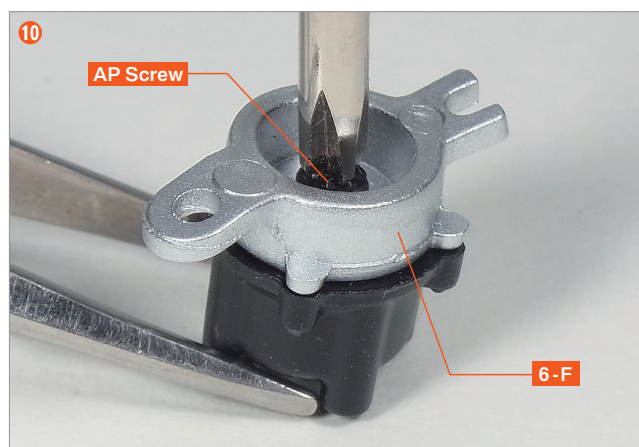

Hold **6-E** and **6-F** together, turn them over, and fasten from the back of **6-F** with an **AP screw**. Hold the parts by hand while doing this.

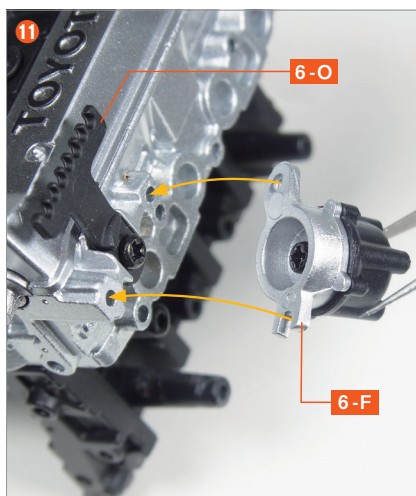

Place **6-F** over **6-O** so that the two screw holes align with the screw holes on **3-G**.

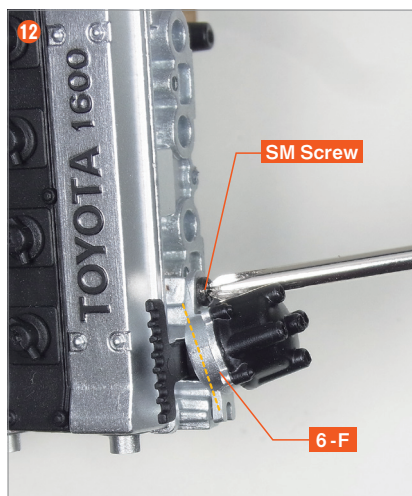

**6-F** is angled, but tighten the **SM screw** vertically into **3-G**. First, secure one side to set the mounting position.

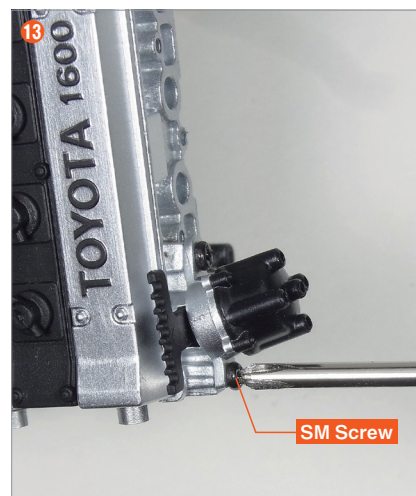

Tighten the other **SM screw** vertically to secure **6-F**.



## step 3 Attach the Oil Filter to the Left Cylinder Block

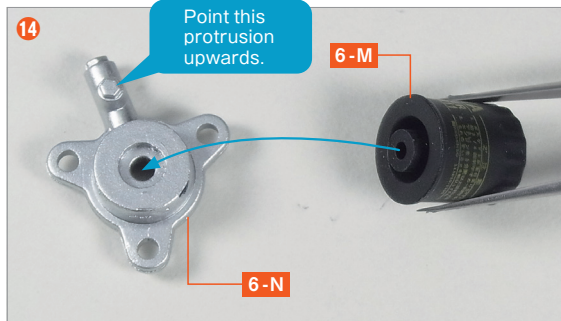

Align the screw hole on the back of the **Oil Filter 6-M** with the screw hole on the **Oil Filter Bracket 6-N**.

Carefully turn **6-M** and **6-N** over without letting them come apart, and secure **6-N** from the back with an **AP screw**.

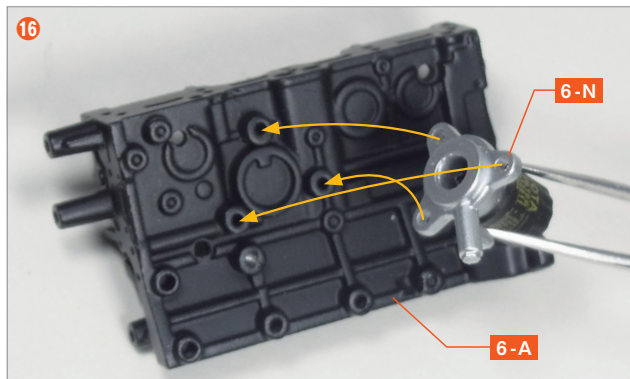
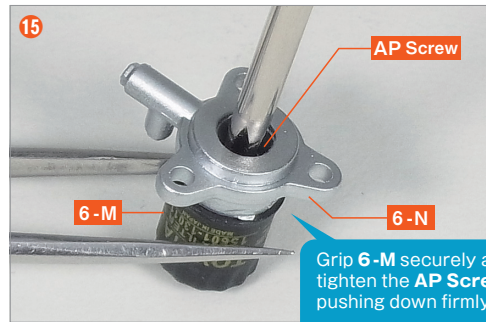

Align the three screw holes of the **Cylinder Block (L) 6-A** and **6-N** as shown.

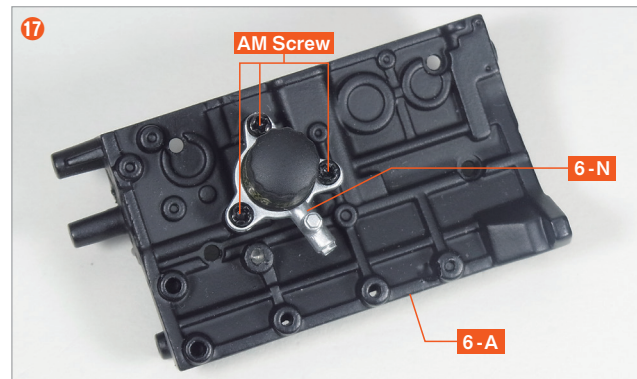

Secure all three points with **AM screws**.

## step 4 Attach the Cylinder Head Rear Plate and Water Hose

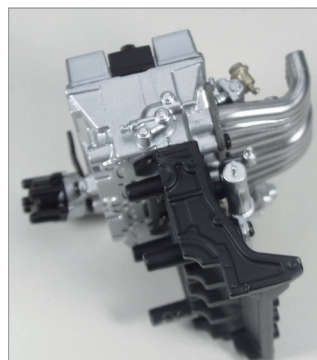
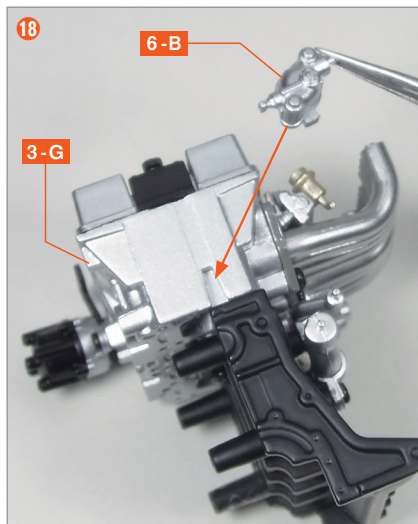

Fit the trapezoidal projection on the back of the **Cylinder Head Rear Plate (6-B)** into the matching recess on the **Cylinder Block**. If **6-B** comes off easily, apply all-purpose glue to its back as shown on the right.

If using all-purpose glue, take a small amount on a toothpick and place tiny dots on the coloured areas as shown.



### Choosing and Using Adhesives

In this model, parts are basically designed to be assembled by fitting and screwing together. However, in cases where a fit alone may become loose or parts might detach, the assembly guide suggests using adhesives as a supplementary measure.

For model building, "instant glue", "all-purpose glue", and "ABS glue" are suitable, but you need to choose the right type depending on the material and purpose. Instant glue sets quickly and is convenient, but it can cause a chemical reaction that leaves a whitish residue, so it is not suitable for visible exterior surfaces. All-purpose glue works on most materials and becomes transparent when cured, giving a clean finish and making it safe for beginners. For bonding ABS parts, ABS glue is the most suitable.

It is also important to use only a small amount of adhesive. Take a tiny amount on the tip of a toothpick and apply it in small dots to the necessary spots.



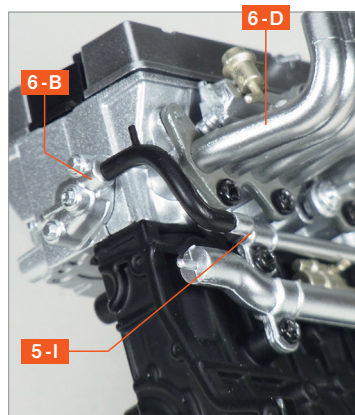
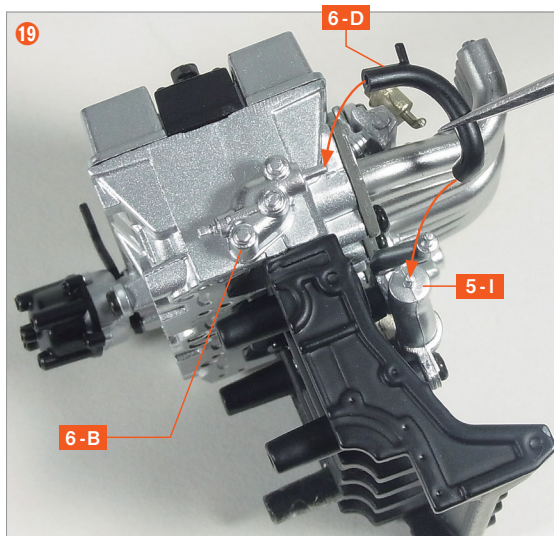

Make sure the orientation is correct, then fit the **Water Outlet Pipe 6-D** into **6-B** and the **Water Bypass Pipe (2) 5-I**.

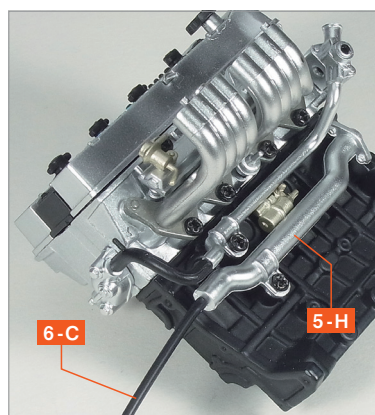
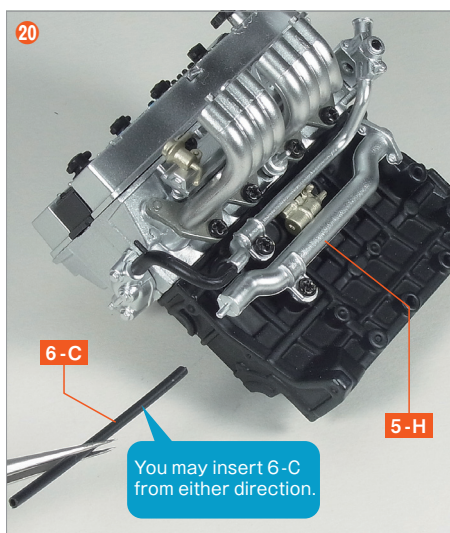
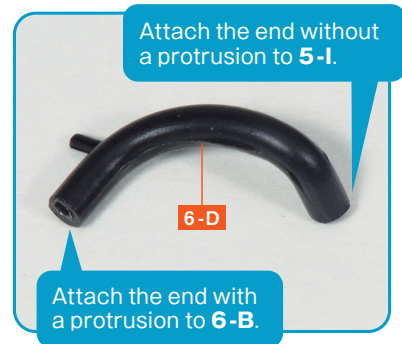

Insert the **Heater Outlet Hose 6-C** onto the protrusion of the **Water Bypass Pipe (1) 5-H**.



## Complete

The assembly for Issue 6 is complete. The Disc Brake has been installed on the left Front Member, and additional details have been added to the Engine Block. The Brake Disc, Washer 6-L, and VM Screw will be used in a later issue, so store them in a resealable plastic bag or similar container to prevent loss. From Issue 7, we will begin assembling the Transmission Case.

